



[www.kings-group.net](http://www.kings-group.net)

Church Langley Way  
Harlow CM17 9TE  
Tel: 01279 410084

Wedgewood Drive, Harlow, CM17 9PY  
Guide Price £200,000

\* Guide price £200,000 - £210,000 \*

Kings Group are pleased to offer For Sale, this ONE BEDROOM APARTMENT on Wedgewood Drive . Located on the desirable Church Langley development to the east of Harlow, this ideal investment or starter property is comprised of open planned lounge & kitchen, double bedroom and bathroom.

The property is very close to the M11 and M25, there are a range of local shops all within walking distance of the property and it also benefits from being walking distance to Tesco superstore. The property is situated within catchment of some of the most sought after schools. Henry Moore Primary School (0.14 Miles) , Church Langley Community Primary School (0.57 Miles). The local bus station is Rushton Grove which is walking distance away ( 0.05 Miles ). The property benefits from having two car driveway.

Lease Term Remaining: 98 Years  
 Service Charge: £1890 P/A  
 Ground Rent: £184 P/A  
 EPC Rating : D

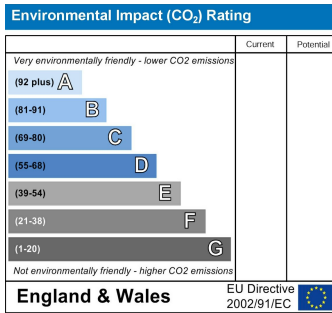
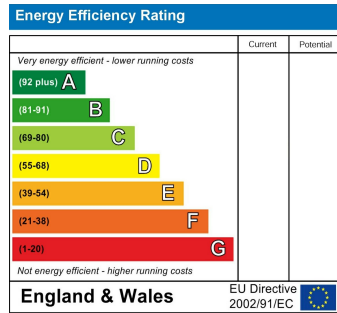

2ND FLOOR

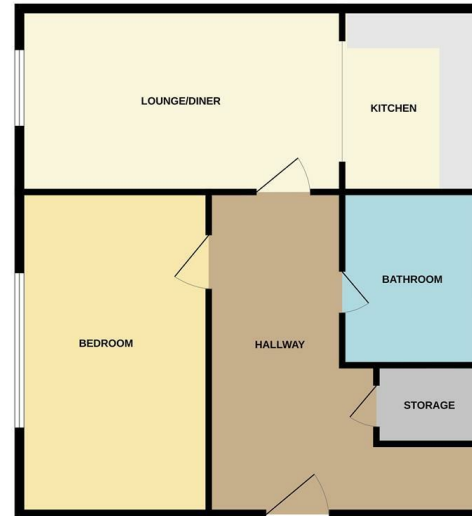

While every attempt has been made to ensure the accuracy of the floorplan contained herein, measurements of floors, windows, doors and any other items are approximate and no responsibility is taken for any error. Measurements are not guaranteed. The plan is the definitive document and should be used as such by any prospective purchaser. The services, systems and appliances shown have not been tested and no guarantee can be given. Made with Metropack (2002)

